

City of Ukiah Parking Map

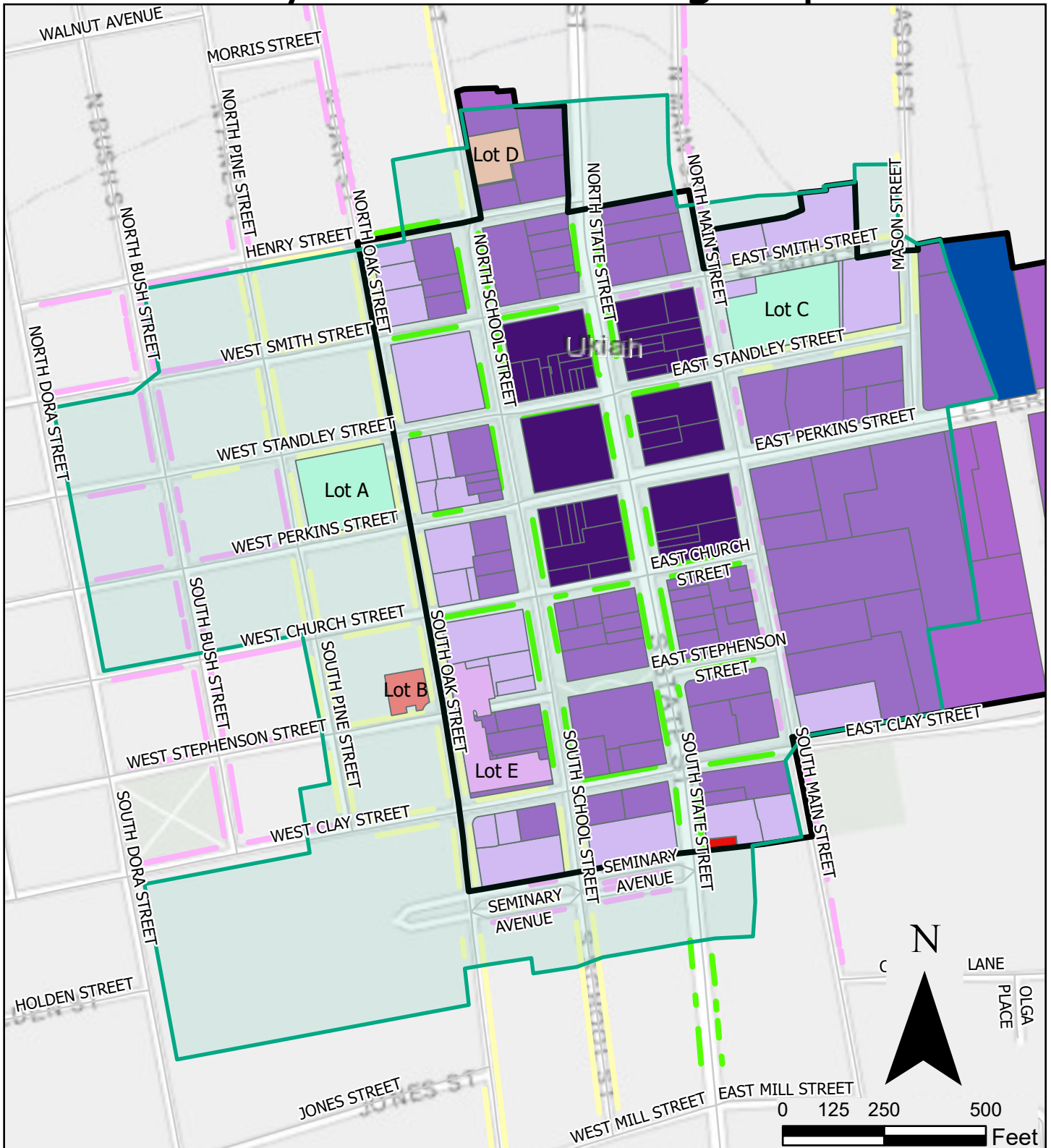

Legend

On Street Parking Restrictions

- 1.5 Hour Parking
- 2 Hour Parking
- 5 Hour Parking

Existing Parking Lots

- Permit Only

- Permit Only Until 3:30 PM

- Public 2 Hour Parking
- Public Long Term
- Downtown Parking District #1

Existing Downtown Zoning

- C1 - Community Commercial
- C2 - Heavy Commercial

- DC - Downtown Core

- GU - General Urban
- UC - Urban Center

- Existing DZC Boundary

- Roads

DO NOT USE TO DETERMINE LEGAL BOUNDARIES. NO WARRANTY, EXPRESSED OR IMPLIED, IS MADE REGARDING ACCURACY, ADEQUACY, COMPLETENESS, LEGALITY, RELIABILITY, OR USEFULNESS OF THIS INFORMATION.